

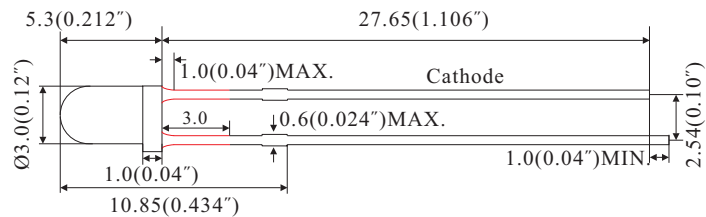

PACKAGE DIMENSION

TY-30UG3W45-600

(OLD P/N: TY-30UG3-34)

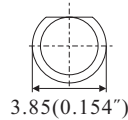

Selection Guide

Part No.	Dice		Lens Color	(If=20mA)	Viewing Angle
	Raw Material	Emitted Color		TYP. (Mcd)	
TY-30UG3W45-600	AlGaInP	Ultra Bright Yellow Green	Water Clear	600	45°

Absolute Maximum Ratings at T_A=25°C

Parameter	Symbol	Maximum Rating	Units
Power Dissipation	PD	78	mW
Peak Forward Current ⁴	IFP	100	mA
Forward Current	IF	30	mA
Reverse Voltage	V _R	5	V
Capacitance	C	20	pF
Operating/Storage Temperature	T _A /T _{STG}	-40°C to +85°C	
Lead Solder Temperature	T _{SOL}	260°C for 3 Seconds	

Electrical / Optical Characteristics at T_A=25°C

Parameter	Symbol	TYP.	MAX.	Units	Test Condition
Peak Wavelength	λ _{peak}	573	-	nm	I _F =20mA
Dominant Wavelength	λ _D	568	-	nm	I _F =20mA
Spectral Line Half-width	Δλ	20	-	nm	I _F =20mA
Forward Voltage	V _F	2.20	2.50	V	I _F =20mA
Reverse Current	I _R	-	10	uA	V _R =5V

Notes:

1. All dimension are in millimeter (inches);
2. Tolerance is ±0.25mm(0.01") unless otherwise specified;
3. Not recommend to solder within 3mm from the resin;
4. 1/10 Duty Cycle, 0.1ms Pulse Width.