

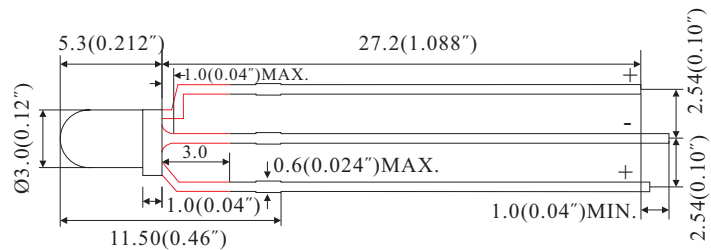

## PACKAGE DIMENSION

**TY-30SR2YG2TM70-60N**

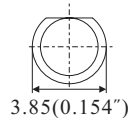

### Selection Guide

Part No.	Dice		Lens Color	(If=20mA)	Viewing Angle
	Raw Material	Emitted Color		TYP. (mcd)	
TY-30SR2YG2TM70-60N	GaAsP	Super Bright Red	Tiny Milky	45	70°
	GaP	Yellow Green		60	70°

### Absolute Maximum Ratings at TA=25°C

Parameter	Symbol	Maximum Rating		Units
		SR	YG	
Power Dissipation	PD	72	65	mW
Peak Forward Current <sup>4</sup>	IFP	100	100	mA
Forward Current	IF	30	25	mA
Reverse Voltage	VR	5	5	V
Capacitance	C	25	45	pF
Operating/Storage Temperature	TA/TSTG	-40°C to +85°C		
Lead Solder Temperature	TSOL	260°C for 3 Seconds		

### Electrical / Optical Characteristics at TA=25°C

Parameter	Symbol	TYP.		MAX.		Units	Test Condition
		SR	YG	SR	YG		
Peak Wavelength	$\lambda_{peak}$	640	572	-	-	nm	IF=20mA
Dominant Wavelength	$\lambda_D$	628	568	-	-	nm	IF=20mA
Spectral Line Half-width	$\Delta\lambda$	40	30	-	-	nm	IF=20mA
Forward Voltage	VF	2.10	2.30	2.50	2.60	V	IF=20mA
Reverse Current	IR	-	-	10	10	uA	VR=5V

Notes:

1. All dimension are in millimeter (inches);
2. Tolerance is  $\pm 0.25\text{mm}(0.01")$  unless otherwise specified;
3. Not recommend to solder within 3mm from the resin;
4. 1/10 Duty Cycle, 0.1ms Pulse Width.