



TOYO LED ELECTRONICS LIMITED

http://www.toyo-led.com

e-mail: sales@toyo-led.com

PACKAGE DIMENSION

TY-30PG33W20-6500

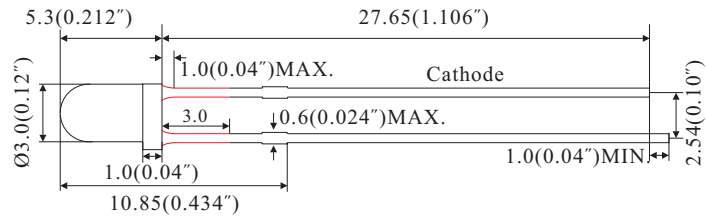
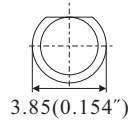

Selection Guide

Part No.	Dice		Lens Color	(If=20mA)	Viewing Angle
	Raw Material	Emitted Color		TYP. (Mcd)	
TY-30PG33W20-6500	InGaN	Pure Green	Water Clear	6500	20°

Absolute Maximum Ratings at TA=25°C

Parameter	Symbol	Maximum Rating	Units
Power Dissipation	PD	120	mW
Peak Forward Current ⁴	IFP	100	mA
Forward Current	IF	30	mA
Reverse Voltage	VR	5	V
Capacitance	C	20	pF
Operating/Storage Temperature	TA/TSTG	-40°C to +85°C	
Lead Solder Temperature	TSOL	260°C for 3 Seconds	

Electrical / Optical Characteristics at TA=25°C

Parameter	Symbol	TYP.	MAX.	Units	Test Condition
Peak Wavelength	λpeak	530	-	nm	IF=20mA
Dominant Wavelength	λD	525	-	nm	IF=20mA
Spectral Line Half-width	Δλ	35	-	nm	IF=20mA
Forward Voltage	VF	3.20	3.40	V	IF=20mA
Reverse Current	IR	-	2	uA	VR=5V

Notes:

1. All dimension are in millimeter (inches);
2. Tolerance is ±0.25mm(0.01") unless otherwise specified;
3. Not recommend to solder within 3mm from the resin;
4. 1/10 Duty Cycle, 0.1ms Pulse Width.